



Solid State Devices, Inc.

14701 Firestone Blvd * La Mirada, Ca 90638
Phone: (562) 404-4474 * Fax: (562) 404-1773
ssdi@ssdi-power.com * www.ssdi-power.com

SDR2GSM & SMS Thru SDR2MSM & SMS

Designer's Data Sheet

Part Number/Ordering Information ^{1/}

SDR2 - - -

- └ Screening ^{2/}
 - - - = Not Screened
 - TX = TX Level
 - TXV = TXV Level
 - S = S Level (for SM, use -S)
- └ Package Type
 - SM = Surface Mount Round Tab
 - SMS = Surface Mount Square Tab
- └ Voltage
 - G = 400 V
 - J = 600 V
 - K = 800 V
 - M = 1000 V

1 AMP ULTRAFAST RECTIFIER 400 – 1000 VOLTS 50 – 70 nsec

FEATURES:

- Ultrafast Recovery: 50-70 ns Max @ 25°C ^{4/}
80-120 ns Max @ 100°C ^{4/}
- PIV to 1000 Volts
- Hermetically Sealed
- Low Reverse Leakage Current
- Single Chip Construction
- For High Efficiency Applications
- Available in Round and Square Tab Versions
- Available in Axial Lead Versions
- TX, TXV, and S-Level Screening Available ^{2/}

MAXIMUM RATINGS ^{3/}

RATING		SYMBOL	VALUE	UNIT
Peak Repetitive Reverse Voltage and DC Blocking Voltage	SDR2G	V_{RRM}	400	V
	SDR2J	V_{RWM}	600	
	SDR2K	V_R	800	
	SDR2M		1000	
Average Rectified Forward Current (Resistive Load, 60 Hz, Sine Wave, $T_A = 25^\circ\text{C}$)		I_O	1	A
Peak Surge Current (8.3 msec Pulse, Half Sine Wave Superimposed on I_O , allow junction to reach equilibrium between pulses, $T_A = 25^\circ\text{C}$)		I_{FSM}	25	A
Operating & Storage Temperature		T_{OP} and T_{STG}	-65 to +175	°C
Thermal Resistance, Junction to End Tab		$R_{\theta JE}$	28	°C/W

NOTES:

- 1/** For ordering information, price, operating curves, and availability - Contact factory.
- 2/** Screening based on MIL-PRF-19500. Screening flows available on request.
- 3/** Unless otherwise specified, all electrical characteristics @ 25°C.
- 4/** Recovery conditions: $I_F = 0.5$ Amp, $I_R = 1.0$ Amp, I_{RR} to .25 Amp.

Surface Mount Round Tab (SM)

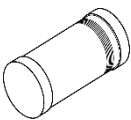

Surface Mount Square Tab (SMS)

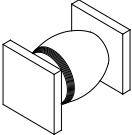



Solid State Devices, Inc.

14701 Firestone Blvd * La Mirada, Ca 90638
 Phone: (562) 404-4474 * Fax: (562) 404-1773
 ssdi@ssdi-power.com * www.ssdi-power.com

SDR2GSM & SMS
 Thru
SDR2MSM & SMS

ELECTRICAL CHARACTERISTICS^{3/}				
CHARACTERISTICS		SYMBOL	MAXIMUM	UNIT
Instantaneous Forward Voltage Drop ($I_F = 1 \text{ Adc}$, 300 μs Pulse, $T_A = 25^\circ\text{C}$)	SDR2GSM – SDR2MSM	V_{F1}	2.8	Vdc
	SDR2GSMS – SDR2JSMS		1.9	
	SDR2KSMS – SDR2MSMS		2.1	
Instantaneous Forward Voltage Drop ($I_F = 1 \text{ Adc}$, 300 μs Pulse, $T_A = -55^\circ\text{C}$)	SDR2GSM – SDR2MSM	V_{F2}	2.95	Vdc
	SDR2GSMS – SDR2JSMS		2.05	
	SDR2KSMS – SDR2MSMS		2.25	
Reverse Leakage Current (Rated V_R , 300 μs Pulse Minimum, $T_A = 25^\circ\text{C}$)		I_{R1}	5	μA
Reverse Leakage Current (Rated V_R , 300 μs Pulse Minimum, $T_A = 100^\circ\text{C}$)		I_{R2}	0.5	mA
Junction Capacitance ($V_R = 10 \text{ Vdc}$, $T_A = 25^\circ\text{C}$, $f = 1 \text{ MHz}$)		C_J	20	pf
Reverse Recovery Time^{4/}	SDR2G-JSM & SMS	t_{RR}	50	ns
	SDR2KSM & SMS		60	
	SDR2MSM & SMS		70	

Round Tab Surface Mount (SM):	DIMENSIONS			Square Tab Surface Mount (SMS):	DIMENSIONS		
	DIM	MIN	MAX		DIM	MIN	MAX
	A	.095"	.105"		A	.127"	.140"
	B	.190"	.210"		B	.200"	.280"
	C	.010"	.030"		C	.022"	.028"
	D	---	---		D	.002"	---

*Dimensions are prior to solder dipping

NOTES:

- 1/ For ordering information, price, operating curves, and availability - Contact factory.
- 2/ Screening based on MIL-PRF-19500. Screening flows available on request.
- 3/ Unless otherwise specified, all electrical characteristics @ 25°C.
- 4/ Recovery conditions: $I_F = 0.5 \text{ Amp}$, $I_R = 1.0 \text{ Amp}$, I_{RR} to 0.25 Amp.