

## Surface Mount Schottky Barrier Rectifier

### FEATURES

- Low power loss, high efficiency
- Ideal for automated placement
- Guardring for overvoltage protection
- High surge current capability
- Moisture sensitivity level : level 1, per J-STD-020
- Compliant to RoHS Directive 2011/65/EU and in accordance to WEEE 2002/96/EC
- Halogen-free according to IEC 61249-2-21 definition

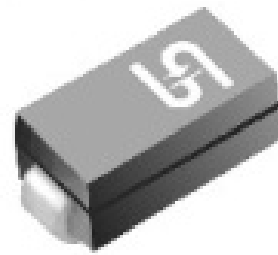

### MECHANICAL DATA

**Case :** DO-214AC(SMA)

Molding compound, UL flammability classification rating 94V-0  
 Base P/N with suffix "G" on packing code - halogen-free, RoHS compliant  
 Base P/N with prefix "H" on packing code - AEC-Q101 qualified

**Terminal :** Matte tin plated leads, solderable per JESD22-B102  
 Meet JESD 201 class 1A whisker test,  
 with prefix "H" on packing code meet JESD 201 class 2 whisker test

**Polarity :** Indicated by cathode band

**Weight :** 0.066 gram (approximately)

**DO-214AC(SMA)**

MAXIMUM RATINGS AND ELECTRICAL CHARACTERISTICS (T <sub>A</sub> =25°C unless otherwise noted)					
PARAMETER	SYMBOL	SSL12	SSL13	SSL14	UNIT
Marking Code		SL12	SL13	SL14	
Maximum repetitive peak reverse voltage	V <sub>RRM</sub>	20	30	40	V
Maximum RMS voltage	V <sub>RMS</sub>	14	21	28	V
Maximum DC blocking voltage	V <sub>DC</sub>	20	30	40	V
Maximum average forward rectified current	I <sub>F(AV)</sub>	1			A
Peak forward surge current, 8.3 ms single half sine-wave superimposed on rated load	I <sub>FSM</sub>	50			A
Maximum instantaneous forward voltage (Note 1) @ 1 A	V <sub>F</sub>	0.39			V
Maximum reverse current @ rated VR	I <sub>R</sub>	0.2			mA
		50			
Typical thermal resistance	R <sub>θJL</sub>	28			°C/W
	R <sub>θJA</sub>	88			
Operating junction temperature range	T <sub>J</sub>	- 55 to + 125			°C
Storage temperature range	T <sub>STG</sub>	- 55 to + 150			°C

Note 1 : Pulse test with PW=300u sec, 1% duty cycle

ORDERING INFORMATION					
PART NO.	AEC-Q101 QUALIFIED	PACKING CODE	GREEN COMPOUND CODE	PACKAGE	PACKING
SSL1x (Note 1)	Prefix "H"	R3	Suffix "G"	SMA	1800 / 7" Plastic reel
		R2		SMA	7500 / 13" Paper reel
		M2		SMA	7500 / 13" Plastic reel
		F3		Folded SMA	1800 / 7" Plastic reel
		F2		Folded SMA	7500 / 13" Paper reel
		F4		Folded SMA	7500 / 13" Plastic reel
		E3		Clip SMA	1800 / 7" Plastic reel
		E2		Clip SMA	7500 / 13" Plastic reel

Note 1: "x" defines voltage from 20V (SSL12) to 40V (SSL14)

EXAMPLE					
PREFERRED P/N	PART NO.	AEC-Q101 QUALIFIED	PACKING CODE	GREEN COMPOUND CODE	DESCRIPTION
SSL14 R3	SSL14		R3		
SSL14 R3G	SSL14		R3	G	Green compound
SSL14HR3	SSL14	H	R3		AEC-Q101 qualified

**RATINGS AND CHARACTERISTICS CURVES**

(TA=25°C unless otherwise noted)

FIG.1 FORWARD CURRENT DERATING CURVE

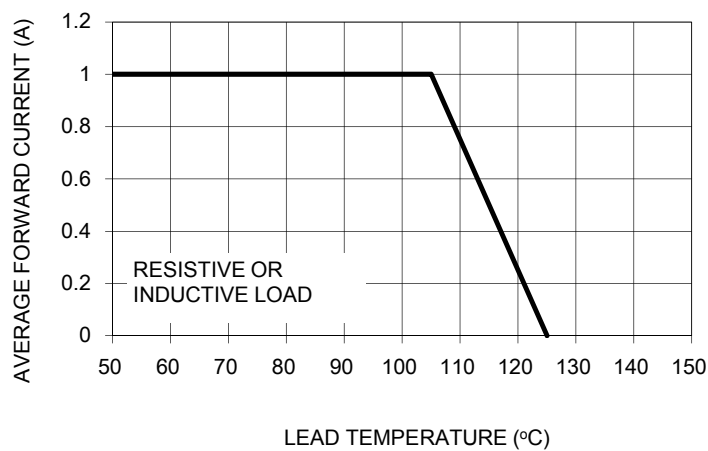

FIG. 2 MAXIMUM NON-REPETITIVE FORWARD SURGE CURRENT

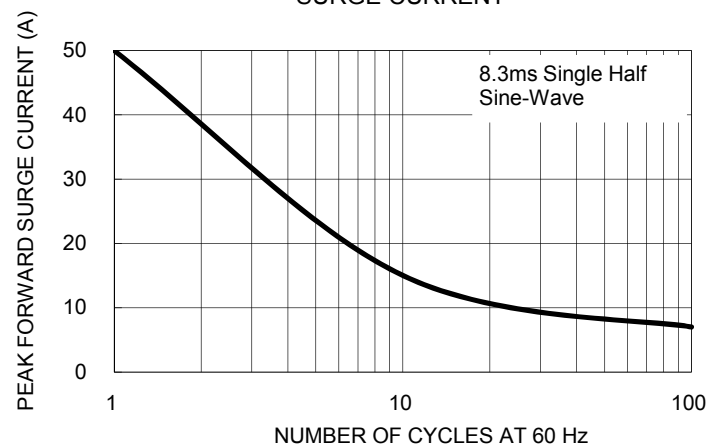

FIG. 3 TYPICAL FORWARD CHARACTERISTICS

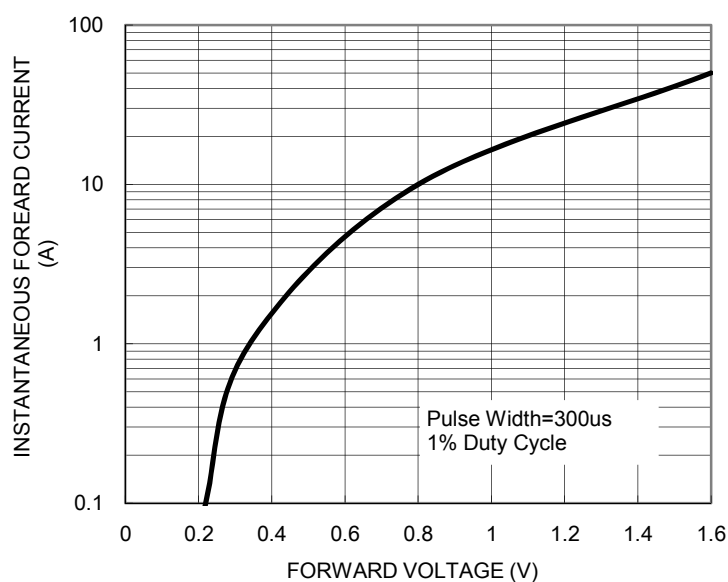

FIG. 4 TYPICAL REVERSE CHARACTERISTICS

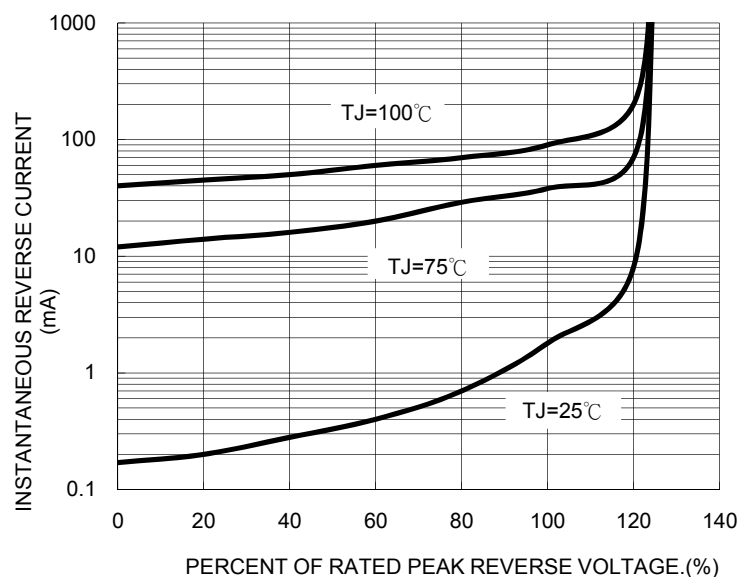
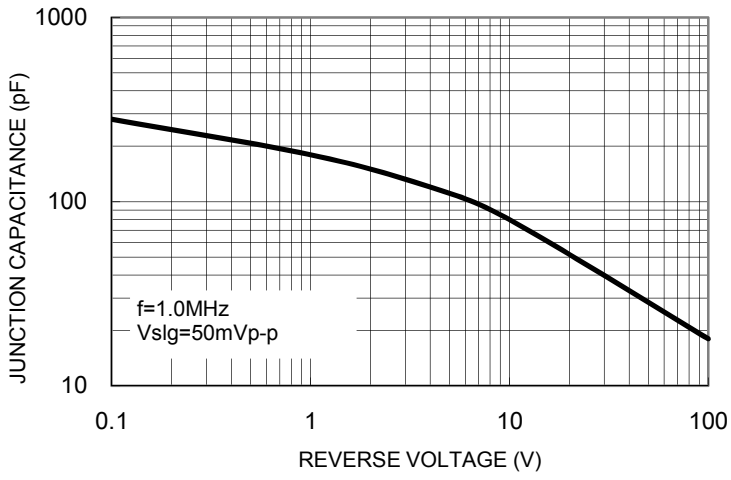
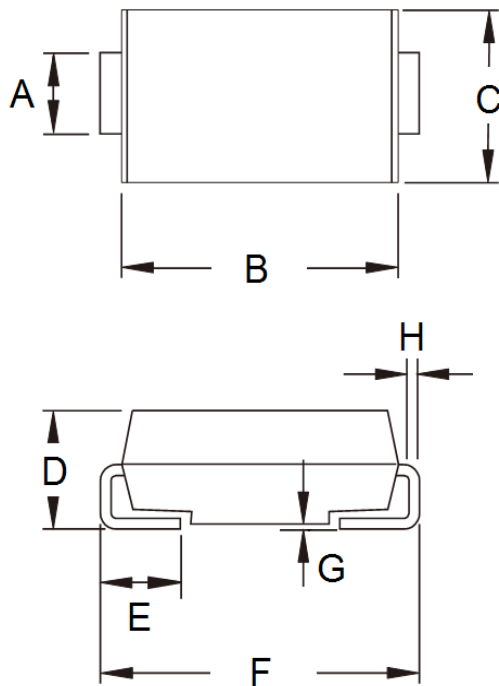

FIG. 5 TYPICAL JUNCTION CAPACITANCE



PACKAGE OUTLINE DIMENSIONS



DIM.	Unit(mm)		Unit(inch)	
	Min	Max	Min	Max
A	1.27	1.58	0.050	0.062
B	4.06	4.60	0.160	0.181
C	2.29	2.83	0.090	0.111
D	1.99	2.50	0.078	0.098
E	0.90	1.41	0.035	0.056
F	4.95	5.33	0.195	0.210
G	0.10	0.20	0.004	0.008
H	0.15	0.31	0.006	0.012

SUGGESTED PAD LAYOUT

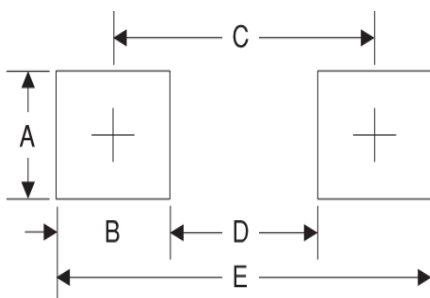

Symbol	Unit(mm)
A	1.68
B	1.52
C	3.93
D	2.41
E	5.45

MARKING DIAGRAM



- P/N = Marking Code
- G = Green Compound
- YW = Date Code
- F = Factory Code